



Panel Cockpit Door A320
A320 Cockpit Door panel

Datos técnicos:

Technical data:

Las medidas del panel (ancho x alto x profundidad) son: 145,5 x 60,6 x 6 mm.

The measurements of the panel (width x height x depth) are: 145,5 x 60,6 x 6 mm.

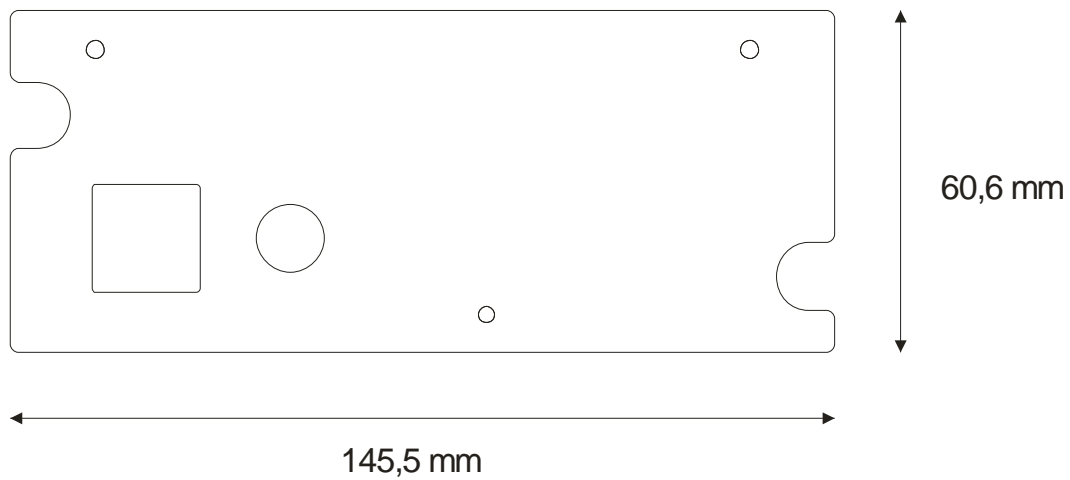

Datos de Montaje:

Assembly data:

Esquema de montaje:

Assembly scheme:

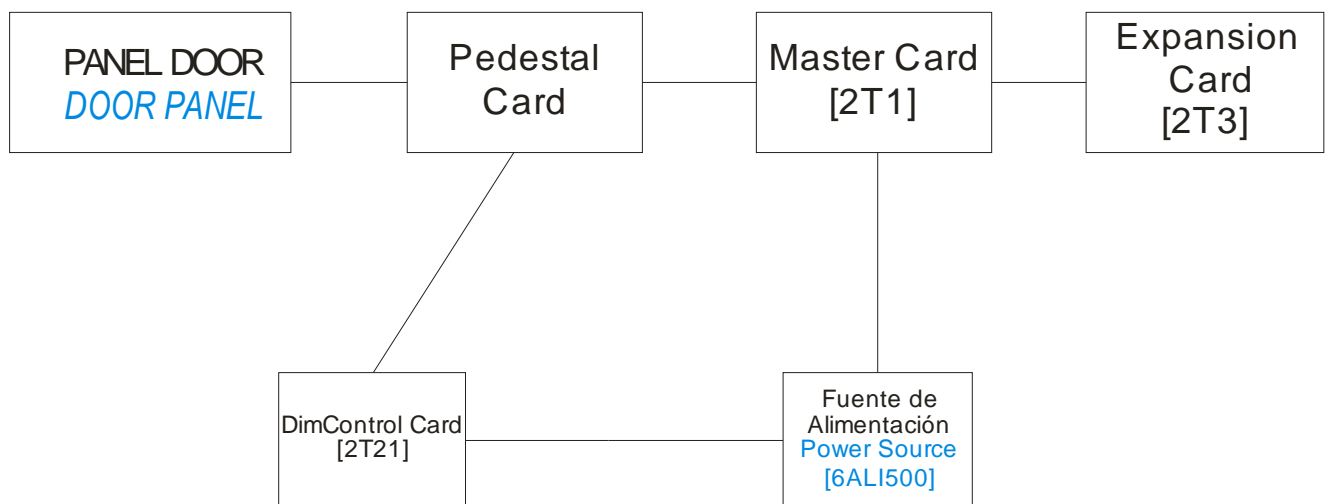

* Ejemplo de cableado del panel.

Panel wiring example.

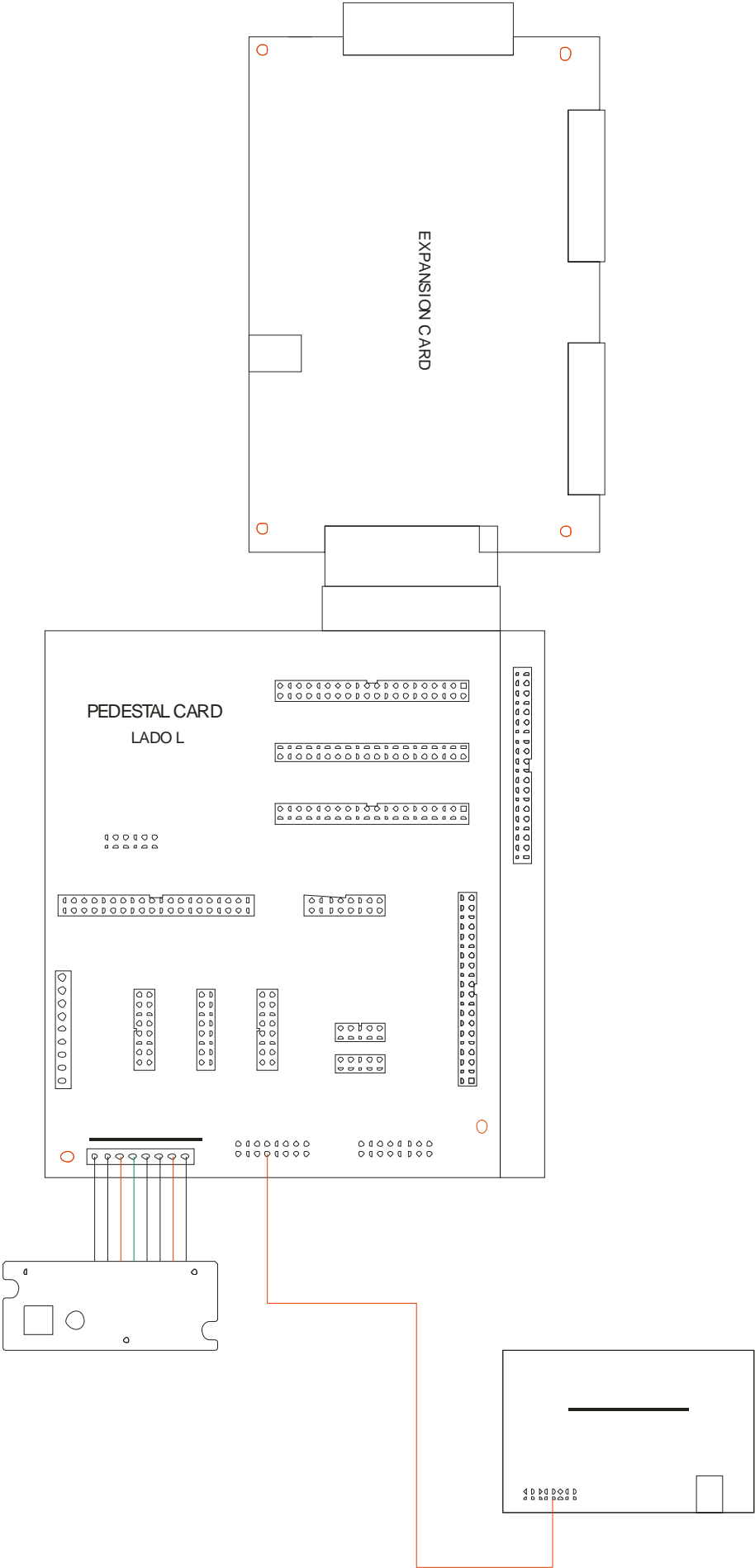

* Cablear el panel a las tarjetas pedestal.

Wiring the panel to the pedestal card.

* Atornillar los tornillos del panel en la estructura del Pedestal.

Fix the panel screws into the Pedestal structure.

Precaución:

Caution:

* Montar y fijar adecuadamente el panel.

Mount and fix the panel properly.

* Panel comprobado para funcionar a la tensión de salida que proporciona la tarjeta master.

Panel checked to operate at the output voltage provided by the Opencockpits Master Card.

Declaración de entradas y salidas:

I/O declaration:

//DOOR INPUTS

VAR 7033, NAME DOOR_UNLOCK, STATIC, LINK IOCARD_SW, DEVICE X, INPUT 40

VAR 7034, NAME DOOR_LOCK, STATIC, LINK IOCARD_SW, DEVICE X, INPUT 41

//DOOR OUTPUTS

VAR 7035, NAME DOOR_KORRY, STATIC, LINK IOCARD_OUT, DEVICE X, OUTPUT 21